



RETAIL SPACE AVAILABLE FOR LEASE

906-912 W. Liberty Drive, Liberty, Missouri



Lease Rate: \$23/SF Full Service | 1,534 SF to 2,776 SF

DEMOGRAPHICS

	1 mile	3 miles	5 miles
Estimated Population	9,087	47,822	77,531
Avg. Household Income	\$95,154	128,397	\$128,071

- Up to 5,501 SF Available
- Great visibility and access from 291 Highway with ample parking
- Well established entertainment/bowling alley operating for 38 years
- 2,776 SF Space is a turn-key bar/lounge with patio
- Planned renovations with three competition pickle ball courts in the near future
- Excellent location in the heart of Liberty off 291 Highway

 [CLICK HERE TO VIEW MORE LISTING INFORMATION](#)

For More Information Contact:

Exclusive Agents
DAKOTA GRIZZLE | 816.412.7395 | dgrizzle@blockandco.com
GARRETT COHOON | 816.412.7315 | gcohoon@blockandco.com



SITE PLAN/PHOTOS

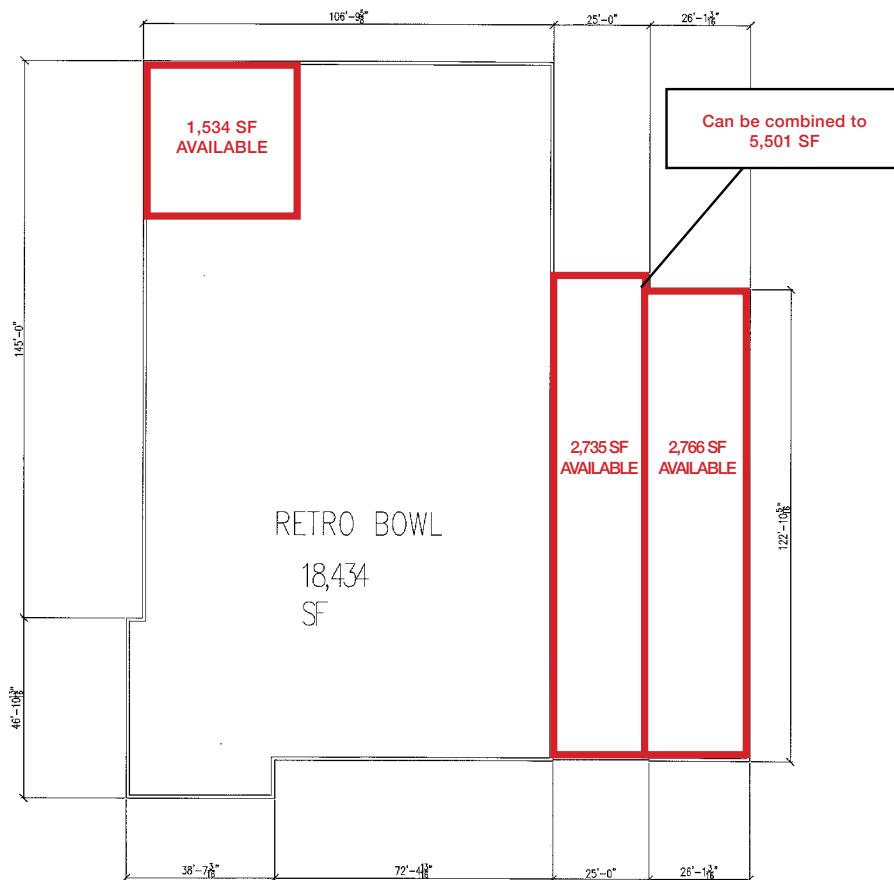

AERIAL

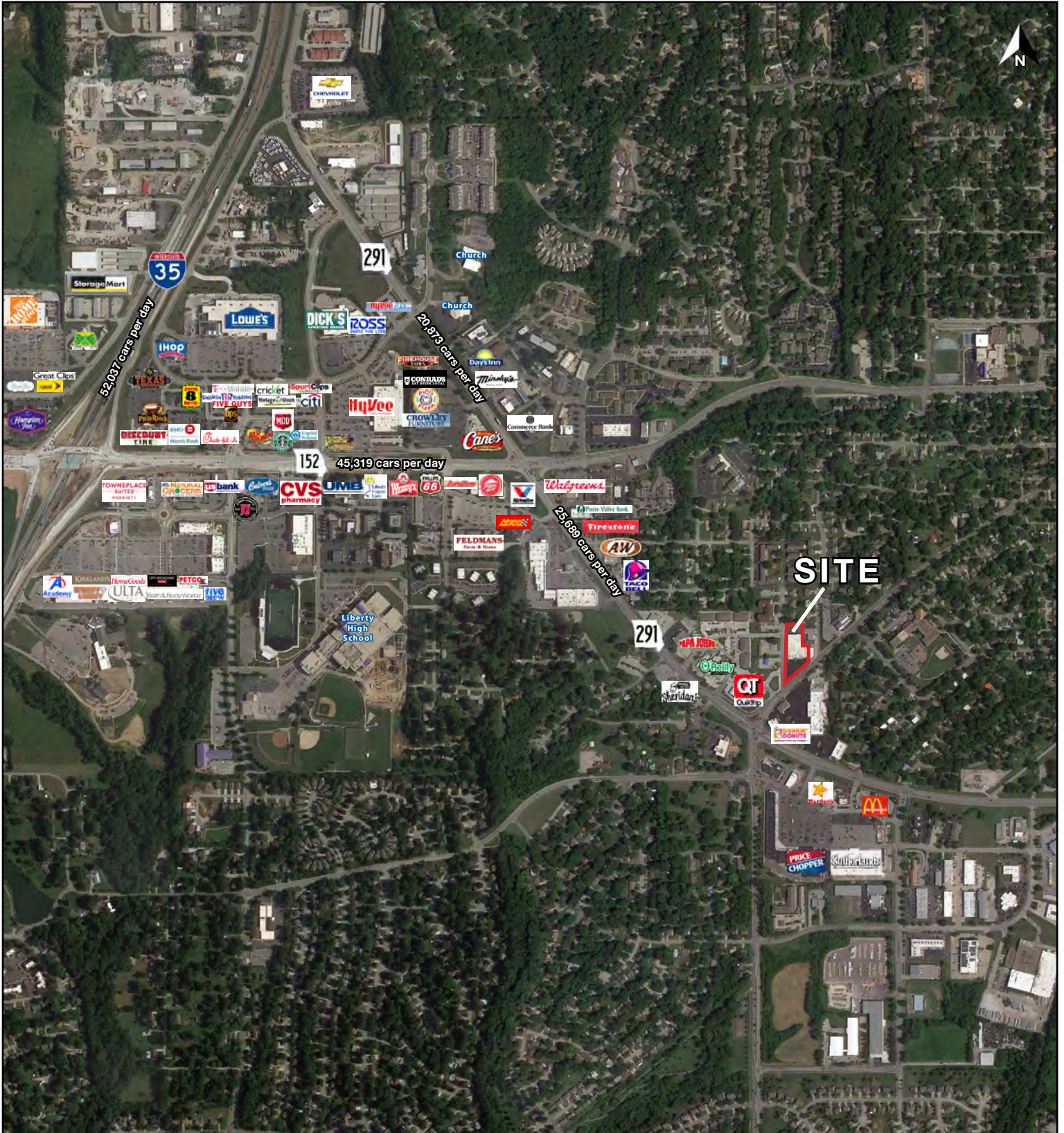

SITE PLAN





RETAIL SPACE AVAILABLE FOR LEASE

906-912 W. Liberty Drive, Liberty, Missouri

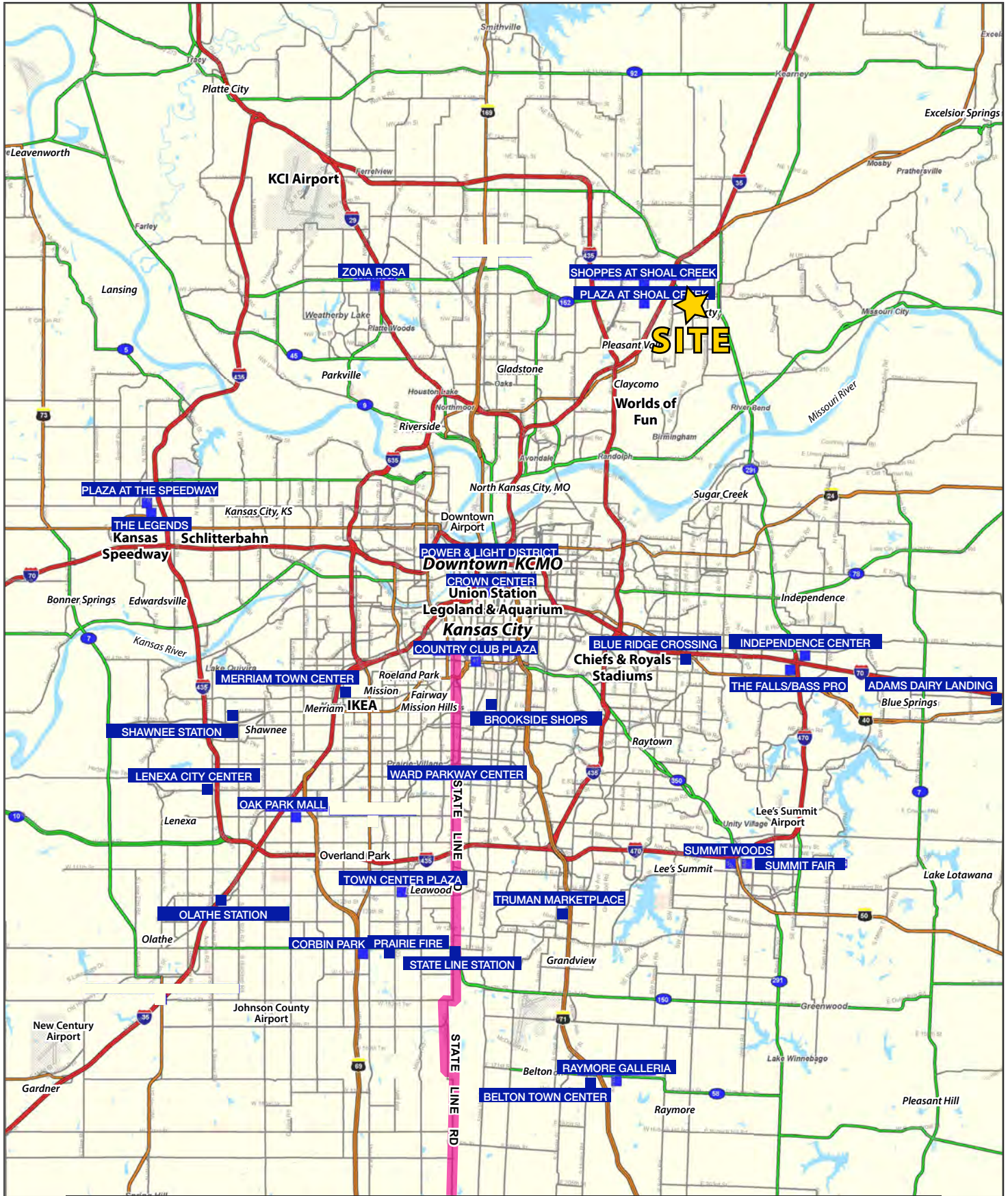



RETAIL SPACE AVAILABLE FOR LEASE

906-912 W. Liberty Drive, Liberty, Missouri

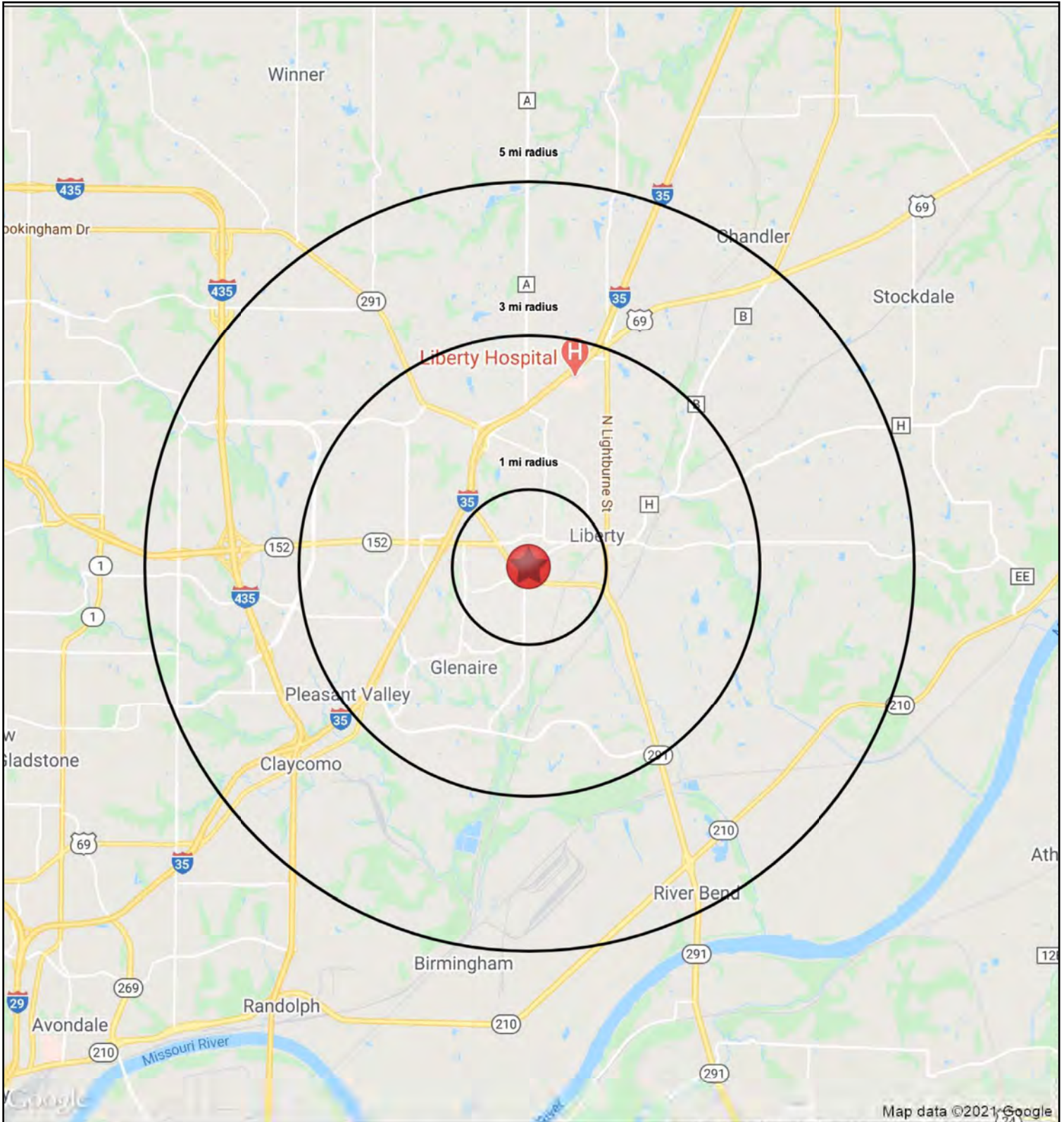



RETAIL SPACE AVAILABLE FOR LEASE

906-912 W. Liberty Drive, Liberty, Missouri

906-912 W. Liberty Drive Liberty, MO 64068	1 mi radius	3 mi radius	5 mi radius
Population			
2023 Estimated Population	9,087	47,822	77,531
2028 Projected Population	9,488	50,550	81,698
2020 Census Population	9,369	46,823	75,627
2010 Census Population	9,183	41,367	64,486
Projected Annual Growth 2023 to 2028	0.9%	1.1%	1.1%
Historical Annual Growth 2010 to 2023	-	1.2%	1.6%
2023 Median Age	39.9	37.6	36.5
Households			
2023 Estimated Households	3,784	18,384	29,482
2028 Projected Households	3,930	19,369	30,967
2020 Census Households	3,816	17,312	27,861
2010 Census Households	3,627	14,962	23,417
Projected Annual Growth 2023 to 2028	0.8%	1.1%	1.0%
Historical Annual Growth 2010 to 2023	0.3%	1.8%	2.0%
Race and Ethnicity			
2023 Estimated White	84.5%	83.0%	82.5%
2023 Estimated Black or African American	5.8%	6.5%	6.6%
2023 Estimated Asian or Pacific Islander	2.2%	3.6%	3.3%
2023 Estimated American Indian or Native Alaskan	0.4%	0.3%	0.3%
2023 Estimated Other Races	7.1%	6.6%	7.2%
2023 Estimated Hispanic	6.6%	6.2%	6.8%
Income			
2023 Estimated Average Household Income	\$95,154	\$128,397	\$128,071
2023 Estimated Median Household Income	\$78,230	\$106,778	\$106,286
2023 Estimated Per Capita Income	\$39,763	\$49,573	\$48,837
Education (Age 25+)			
2023 Estimated Elementary (Grade Level 0 to 8)	3.0%	2.1%	1.8%
2023 Estimated Some High School (Grade Level 9 to 11)	2.6%	2.4%	2.7%
2023 Estimated High School Graduate	20.7%	22.5%	23.7%
2023 Estimated Some College	22.5%	21.7%	21.9%
2023 Estimated Associates Degree Only	11.6%	9.2%	9.1%
2023 Estimated Bachelors Degree Only	26.4%	28.1%	26.9%
2023 Estimated Graduate Degree	13.2%	14.0%	14.0%
Business			
2023 Estimated Total Businesses	724	1,700	2,191
2023 Estimated Total Employees	5,652	16,408	20,909
2023 Estimated Employee Population per Business	7.8	9.6	9.5
2023 Estimated Residential Population per Business	12.6	28.1	35.4